



**MACHINE  
GREATNESS™**

# LEO 1600



---

**6 inch Compact  
Turning Center**

---

**LEO 1600**

---

ver. EN 171130 SU

## Basic structure

The 30° slant bed includes stable support structure with highly rigid roller type LM guideway for reliable machining.

### A small footprint with big capabilities

The machine is a compact design with 1850 mm width and comes with a 175 mm X-axis stroke and 330 mm Z-axis stroke.

#### Travel

**X-axis** **175 mm**  
(6.9 inch)

**Z-axis** **330 mm**  
(13.0 inch)

#### Rapid feederate

**X / Z-axis** **30 m/min**  
(1181.1 ipm)

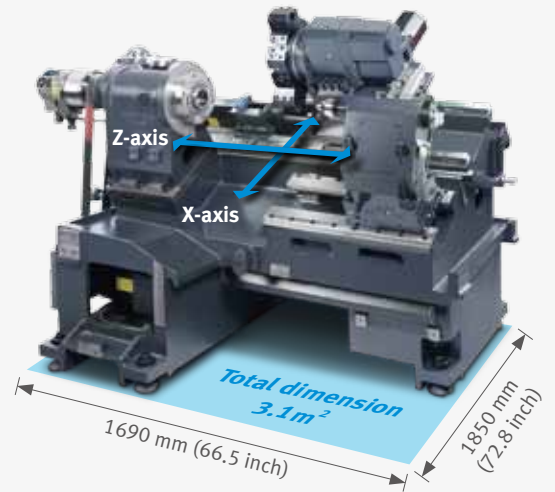

## Machining area

LEO 1600 offers the largest machining area in its class.

#### Bar working diameter

**45 mm** (1.8 inch)

#### Max. Allowable workpiece weight (including chuck)

**Chuck work** **70 kg**  
(154.3 lb)

**Shaft work** **150 kg**  
(330.7 lb)

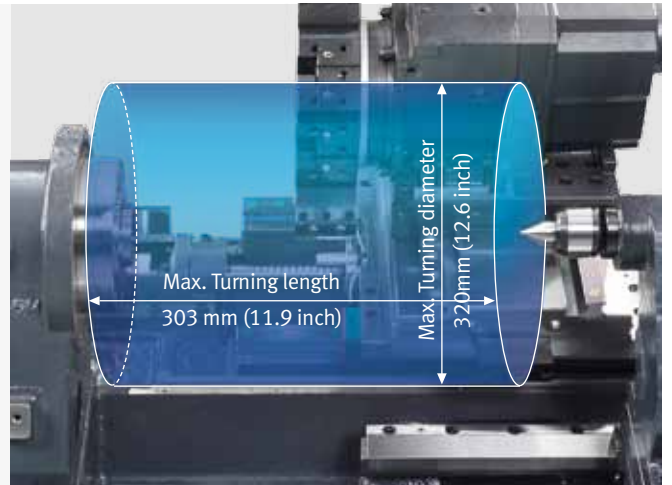

## High reliable spindle

#### Chuck size

**170 mm**  
(6 inch)

#### Spindle speed

**4000 r/min**

#### Max. Spindle power

**7.5 kW** (10.1 Hp)



### NC : DOOSAN FANUC i series

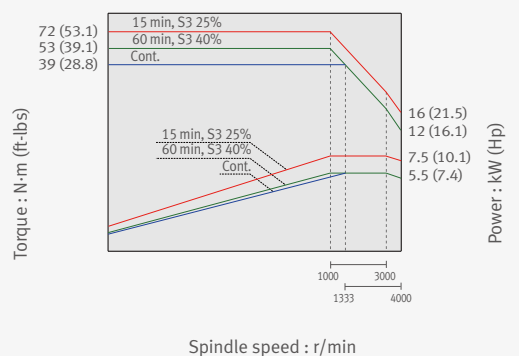

## Turret

The durable eight station turret ensures stable tool rotation and increase machine performance.

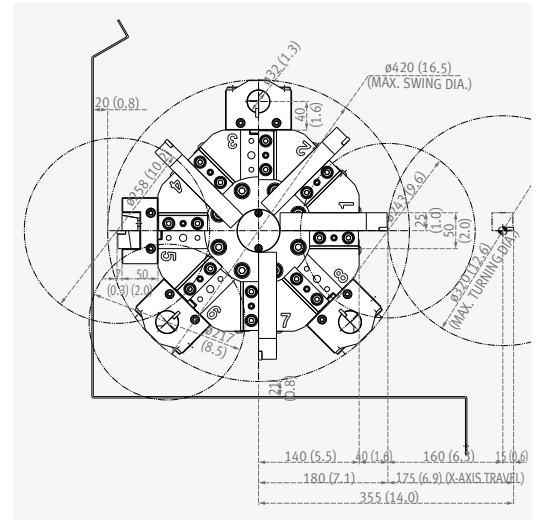

## Tailstock option

Rigid tailstock is available to provide stable support of long workpieces.

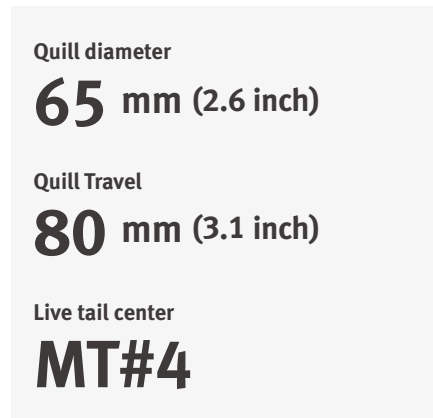

## Ease of Operation

### User friendly Design for ease of operation

- Easy monitoring with reclined front window.
- Rear side chip disposal
- Routine maintenance details are placed in front



For reducing operator workload, designed wide door opening



## Major Specifications

### LEO 1600



Description		Unit	LEO 1600
Capacity	Max. Turning diameter	mm (inch)	320 (12.6)
	Max. Turning length	mm (inch)	303 (11.9)
	Chuck size	inch	170 (6") {8"}*
	Bar working diameter	mm (inch)	45 (1.8)
Travels	Travel distance X / Z axis	mm (inch)	175 / 330 (6.9 / 13.0)
	Rapid Traverse Rate X / Z axis	m/min (ipm)	30 / 30 (1181.1 / 1181.1)
Spindle	Max. Spindle speed	r/min	4000
	Spindle nose	ASA	A2-5
	Main spindle motor power	kW (Hp)	7.5/5.5 (10.1/7.4)
	Spindle bearing diameter	mm (inch)	90 (3.5)
	Spindle through hole diameter	mm (inch)	61 (2.4)
	Max. Spindle Torque for Turning	N-m (ft-lbs)	71.6 (52.8)
Machine Dimensions	Length / Width / Height	mm (inch)	1690 / 1850 / 1635 (66.5 / 72.8 / 64.4)
	NC system		DOOSAN FANUC i series
	Monitor		8.4" Color LCD

\*{ } : Option

### External Dimensions

Top view

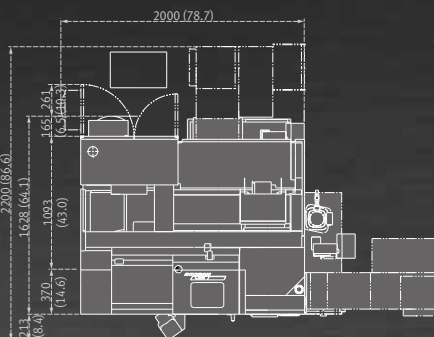

front view

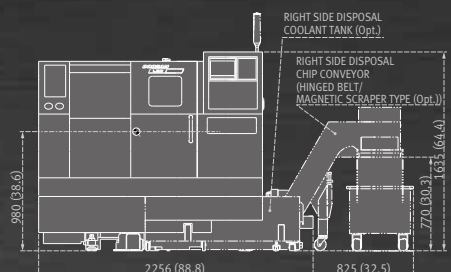

## Doosan Machine Tools

<http://www.doosanmachinetools.com>

[www.facebook.com/doosanmachinetools](https://www.facebook.com/doosanmachinetools)

[www.youtube.com/c/DoosanMachineToolsCorporation](https://www.youtube.com/c/DoosanMachineToolsCorporation)

**MACHINE  
GREATNESS™**

#### Head Office

Yeonkang Bldg., 6th FL., 270, Yeonji-dong,  
Jongno-gu, Seoul, Korea

Tel +82-2-3670-5345 / 5362

Fax +82-2-3670-5382

#### Doosan Machine Tools China

Room 101,201,301, Building 39 Xinzhuang Highway  
No.258 Songjiang District,China Shanghai(201612)

Tel +86-21-5445-1155

Fax +86-21-6405-1472

#### Doosan Machine Tools Japan

#2412, Mita Kokusai Bldg. 1-4-28 Mita,  
Minato-ku, Tokyo 108-0073, Japan

Tel +81-3-5730-9013

Fax +81-3-5730-9016

#### Doosan Machine Tools America

19A Chapin Rd., Pine Brook, NJ 07058, U.S.A.

Tel +1-973-618-2500

Fax +1-973-618-2501

#### Doosan Machine Tools Europe

Emdener Strasse 24, D-41540 Dormagen, Germany

Tel +49-2133-5067-100

Fax +49-2133-5067-111

#### Doosan Machine Tools India

106 / 10-11-12, Amruthahalli, Byatarayanapura,  
Bellary road, Bangalore-560 092, India

Tel +91-80-4266-0122 / 121 / 100

\* For more details, please contact Doosan Machine Tools.

\* The specifications and information above-mentioned may be changed without prior notice.

\* Doosan Machine Tools Co., Ltd. is a subsidiary of MBK Partners. The trademark **DOOSAN** is used under a licensing agreement with Doosan Corporation, the registered trademark holder.

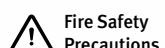

There is a high risk of fire when using non-water-soluble cutting fluids, processing flammable materials, neglecting use coolants and modifying the machine without the consent of the manufacturer. Please check the SAFETY GUIDANCE carefully before using the machine.